

A - A SECTION

D - D SECTION

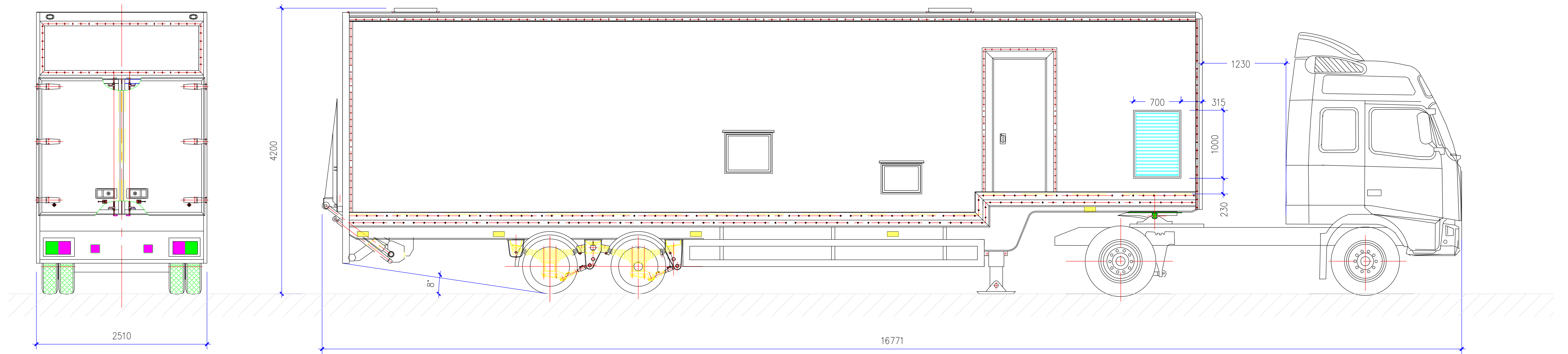

C - C SECTION

B - B SECTION

COPYRIGHT ©
 THIS DRAWING IS THE PROPERTY OF CHANGSHU SLAUGHTERHOUSE EQUIP. CO., LTD. AND IS FURNISHED ON THE EXPRESSED UNDERSTANDING THAT NO PART OF IT SHALL BE COPIED, REPRODUCED, LENT OR DISPOSED OF TO OTHERS, DIRECTLY OR INDIRECTLY, NOR USED FOR ANY PURPOSE OTHER THAN THAT FOR WHICH IT IS SPECIFICALLY ISSUED.
 THIS DOCUMENT OR COMPUTER FILE IF ISSUED AS THIS MUST NOT BE COPIED, SCANNED, CONVERTED TO CAD ELECTRONIC FILE FORMAT OR REVERSE ENGINEERED WITHOUT WRITTEN APPROVAL FROM CHANGSHU SLAUGHTERHOUSE EQUIP. CO., LTD.

<input type="checkbox"/> TECHNICS	<input type="checkbox"/> BUILDING
<input checked="" type="checkbox"/> STRUCTURE	<input type="checkbox"/> WATER SPLY & DRNG
<input type="checkbox"/> ELECTRICAL	<input type="checkbox"/> VENTILATION
<input type="checkbox"/> REFRIGERATION	<input type="checkbox"/> OTHERS

REV	DATE	DESCRIPTION
A	20.7.10	FINAL DESIGN

GENERAL NOTES
 1) ALL ARCHITECTURAL DRAWINGS TO BE READ IN CONJUNCTION WITH ENGINEERS DRAWINGS.
 2) BUILDER TO CHECK ALL DRAWINGS BEFORE COMMENCING WORK. ALL DIMENSIONS TO BE CHECKED ON SITE WITH ARCHITECTURAL DRAWINGS AND ANY DISCREPANCIES TO BE REPORTED TO BOTH THE DESIGNER AND THE ENGINEER.

PROJECT
 LIVESTOCK SLAUGHTER TRUCK

CLIENT

DESIGNED BY
 **CHANGSHU SLAUGHTERHOUSE EQUIPMENT CO., LTD.**
 MEAT INDUSTRIAL RESEARCH LAB

IDEA FOR SAFETY MEAT TURNKEY PROJECTS
 27# ZHIWANG ROAD, DONGBANG, CHANGSHU, JIANGSU, CHINA, 215534

PHONE: +86 512 5268 7265
 FAX: +86 512 5268 2299
 EMAIL: XISIJULUNG@YAHOO.COM.CN

SHEET		
CATTLE SLAUGHTER TRUCK SECTION VIEW		
DISCIPLINE	TECHNICS	DWN SIZE
DATE	JUL 2010	A-3
DWN	KEN ZHANG	
CHKD		
REVISION		
01720-F-A2		

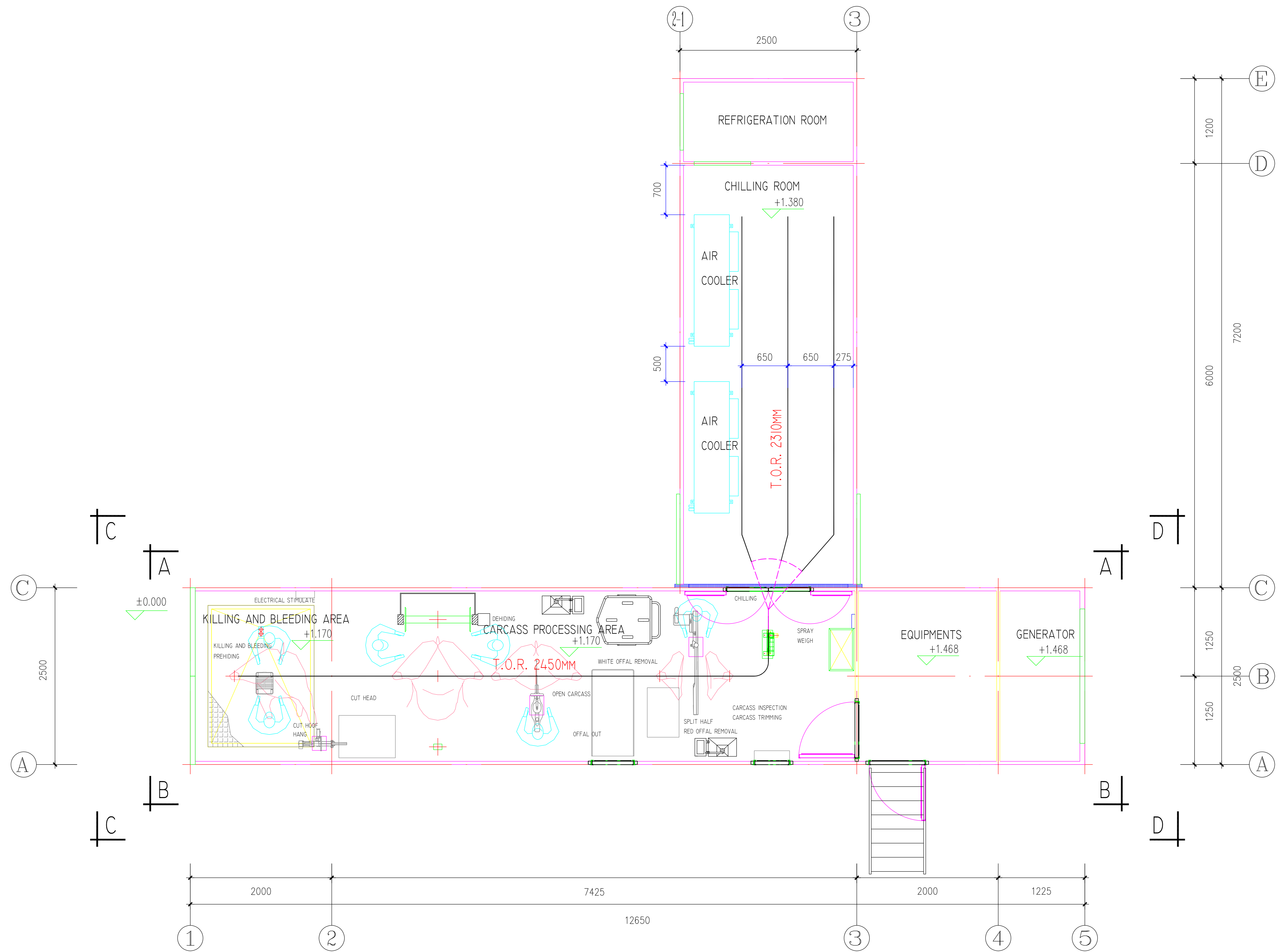

COPYRIGHT ©
 THIS DRAWING IS THE PROPERTY OF CHANGSHU SLAUGHTERHOUSE EQUIP. CO., LTD. AND IS FURNISHED ON THE EXPRESSED UNDERSTANDING THAT NO PART OF IT SHALL BE COPIED, REPRODUCED, LENT OR DISPOSED OF TO OTHERS, DIRECTLY OR INDIRECTLY, NOR USED FOR ANY PURPOSE OTHER THAN THAT FOR WHICH IT IS SPECIFICALLY ISSUED.
 THIS DOCUMENT OR COMPUTER FILE IF ISSUED AS THIS MUST NOT BE COPIED, SCANNED, CONVERTED TO CAD ELECTRONIC FILE FORMAT OR REVERSE ENGINEERED WITHOUT WRITTEN APPROVAL FROM CHANGSHU SLAUGHTERHOUSE EQUIP. CO., LTD.

<input checked="" type="checkbox"/> TECHNICS	<input type="checkbox"/> BUILDING
<input type="checkbox"/> STRUCTURE	<input type="checkbox"/> WATER SPLY & DRNG
<input type="checkbox"/> ELECTRICAL	<input type="checkbox"/> VENTILATION
<input type="checkbox"/> REFRIGERATION	<input type="checkbox"/> OTHERS

REV	DATE	DESCRIPTION
A	20.7.10	FINAL DESIGN

GENERAL NOTES

- ALL ARCHITECTURAL DRAWINGS TO BE READ IN CONJUNCTION WITH ENGINEERS DRAWINGS.
- BUILDER TO CHECK ALL DRAWINGS BEFORE COMMENCING WORK. ALL DIMENSIONS TO BE CHECKED ON SITE WITH ARCHITECTURAL DRAWINGS AND ANY DISCREPANCIES TO BE REPORTED TO BOTH THE DESIGNER AND THE ENGINEER.

PROJECT
 LIVESTOCK SLAUGHTER TRUCK

CLIENT

DESIGNED BY
 **CHANGSHU SLAUGHTERHOUSE EQUIPMENT CO., LTD.**
 MEAT INDUSTRIAL RESEARCH LAB

IDEA FOR SAFETY MEAT TURNKEY PROJECTS

27# ZHIWANG ROAD, DONGBANG, CHANGSHU, JIANGSU, CHINA, 215534

PHONE: +86 512 5268 7265
 FAX: +86 512 5268 2299
 EMAIL: XISIJULUNG@YAHOO.COM.CN

SHEET		
CATTLE SLAUGHTER TRUCK LAYOUT		
DISCIPLINE	TECHNICS	DWN SIZE
DATE	JUL 2010	A-3
DWN	KEN ZHANG	
CHKD		
REVISION		01720-F-A2